

CARDANO



CARDANO

Length: 21.00 metres (68' 11")

Beam: 5.15 metres (16' 11")

Draft: 1.6 metres (5' 3")

Number of Guests: 8

Number of Crew: 2

Built: 2012

Refit: 2015

Builder: Sunseeker

Flag: Netherlands

Hull Construction: GRP

Hull Configuration: Displacement

Air conditioning, WiFi connection on board

Cardano is fast and sleek Manhattan 63 model with a modern and stylish décor.

Able to welcome up to eight guests, like all Sunseeker designs Cardano boasts generous proportions with plenty of onboard space for her charter guests to enjoy. Her four guest cabins include two doubles and two twins, including a large master and VIP that are both ensuite and with full entertainment systems.

Cardano' welcoming interior features American walnut finishes, paired with oversized windows for a light and bright

feel. The main saloon is a large space that includes lounge seating, a retractable TV, dinette and a modern open plan galley. The main saloon leads directly out to the covered aft deck, which is home to a full dining table. Stepped access leads seamlessly down to the large swimming platform and inviting waters.

Guests will delight in the flybridge, which is a large haven with optional shading, a full dining table, large sunpads, navigation station, and uninterrupted views across the ocean. Yet more space to relax is on the forward deck, which is home to large sunpads – popular both for relaxing in Croatia's balmy weather or gathering for evening sundowners.

Cruising at 22 knots, Cardano moves from destination to destination with speed, making her perfect for a busy charter itinerary in the vibrant Croatian waters. Guests can also make use of her on-board water equipment, including Avon 320 RIB, snorkeling equipment and a stand up paddle board.

Complementing her beautiful design, Cardano is sure to appeal thanks to her incredible cruising grounds. Based on Trogir, which has built a reputation as a luxurious and well-developed tourist destination and is easily accessed from nearby airports.

KEY FEATURES

- 1 Accommodates 8 Guests in 4 modern Cabins
- 2 Fresh and modern interior
- 3 Wide windows in master cabin
- 4 Experienced and professional crew



Exterior



Exterior



Exterior



Exterior



Aft Deck



Aft Deck



Salon



Salon and Dining



Galley



Master Cabin



Master Cabin



VIP Cabin



Twin Cabin



Pilothouse



Flybridge



Flybridge



Flybridge



Flybridge



Flybridge



Flybridge



Flybridge



Exterior



Exterior



Exterior



Aerial



Gocycle



Aft

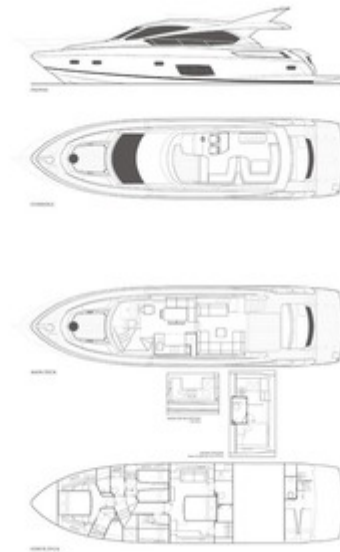

Layout

SPECIFICATIONS

ACCOMMODATION

Number of Guests: 8

Number of Cabins: 4

Cabin Configuration: 2 Double, 2 Twin

EQUIPMENT

Engines: Volvo IPS 1200 900HP

Cruising Speed: 22 knots

Fuel Consumption: 400 Litres/Hr

WATERSPORTS

Tenders + Toys: Tender Williams 325

Jet Ski Seadoo GTX 230

Seabob F5s

SUP x 1

Doughnut x 1

Wakeboard x 1

Snorkelling equipment

Nauti Buoy Inflatable Platform

LAYOUT



PROFILE

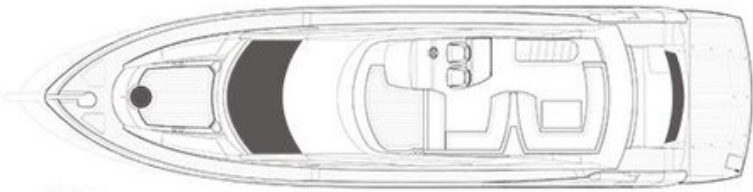

FLYBRIDGE

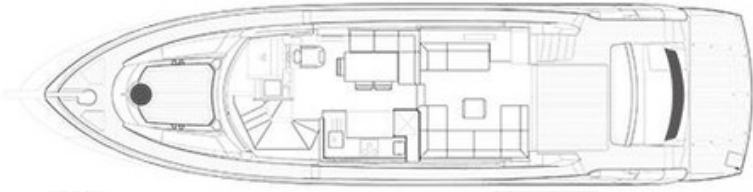

MAIN DECK

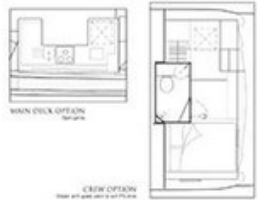

MAIN DECK OPTIONS

CREW OPTIONS

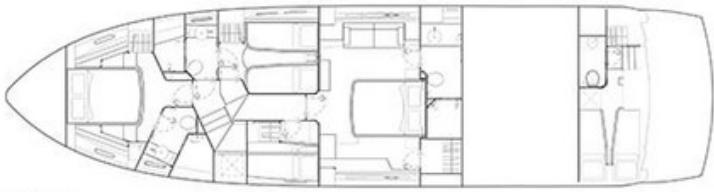

LOWER DECK

INVICTUMMARE

info@invictummare.com

[invictummare.com](https://www.invictummare.com)

Disclaimer

This document is not contractual. All specifications are given in good faith and offered for informational purposes only. The publisher and company do not warrant or assume any legal liability or responsibility for the accuracy, completeness, or usefulness of any information and/or images displayed. Yacht inventory, specifications and charter prices are subject to change without prior notice. None of the text and/or images used in this brochure may be reproduced without written consent from the publisher.